

R1A1 is back — newly improved

R1A1PL

+PLUS

Long stroke

Compact size with a long stroke — sets blind rivets in a single operation.

Lightest (1.16KG)

Aluminum and resin construction for a more compact, lightweight design — optimized balance with weight concentrated in the grip.

On-board vacuum system

ON: Improved efficiency
OFF: Saves compressor power while enhancing tool performance.

Boosted strength

New colors

Easy to service

Check here for details



MADE IN JAPAN

Air inlets on both sides for flexible, easy operation.

Alongside the next-generation standard R2A1, built for ultimate durability, the R1A1 is back — redesigned for professionals who demand in-house maintenance. Proven performance, now with optimized internals for even greater reliability.

Simplified structure designed for easy user maintenance!

POINT 1

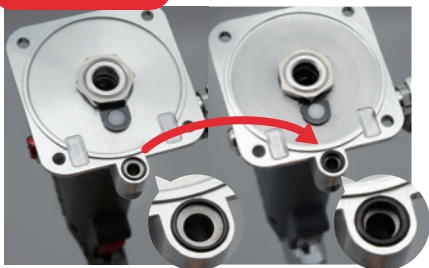

Improved O-Ring between Cylinder cup and Cap to prevent it from coming off during maintenance.

POINT 2



Fewer parts by integrating Frame cap and Inner shaft — enhancing strength and simplifying the design for easier maintenance.

POINT 3



Mandrel shutter redesigned as Mandrel guard for fewer malfunctions and easier cleaning.

New look. Suitable colors for workplace.



Subtle, jobsite-friendly color schemes.

Dual-side air inlets



Air inlets on both sides — easily switched to your workflow.

Easier to clean. Built to last.



Frame cap upgraded from die casting to machining — enhancing durability.

19mm long stroke

Compact size with a long stroke — sets blind rivet in a single operation.



Features

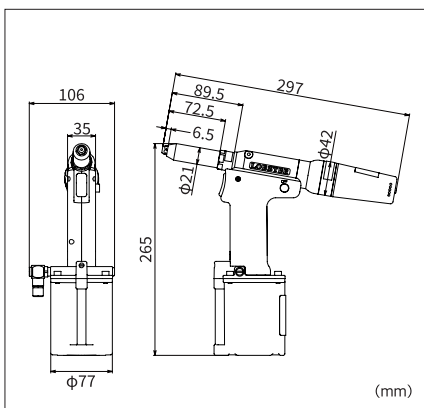

■ On-board vacuum system

Specifications

Main body	Model Number	R1A1PL
	Weight	1.16kg
	Riveting Capacity	φ2.4、φ3.2、φ4.0、φ4.8 (All items on our list) Compatible products: Enhanced rivet NSTB on our list
	Stroke	19mm
	Working Air Pressure	0.5~0.6MPa
	Output Force	Pulling Force 9.0kN (Vaccum on under 0.6MPa)
	Noise Level (dB)	LAeq: LAeq (dB) Less than 75dB.
Air Consumption	82L/min以下 (Vaccum on under 0.6MPa)	
Package Contents	Nosepiece (φ2.4, 3.2*, 4.0, 4.8)、Guide Tube (φ2.4, 3.2)*	

*Pre-installed on the tool

⚠ For safety

● Read and understand the attached “Quick Guide” before use.

- Specifications are subject to change without notice for product improvement.
- Dimensions and specifications are nominal and may vary slightly.

**Monodzukuri solutions for professionals.
Monodzukuri fun for everyone.**

LOBTEX CO.,LTD.

HP <https://www.lobtex.co.jp/tabid/130/Default.aspx>